

wind·n·wood

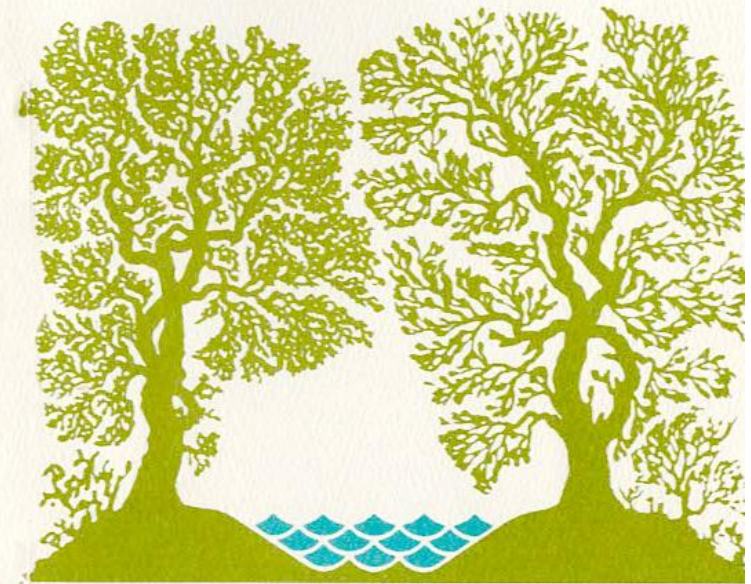
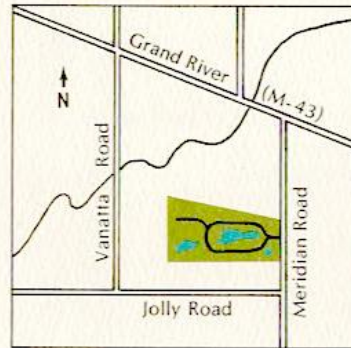

Out here, just
minutes away, there's a place
where peace and beauty co-exist.

Broad fields, natural
woodlands, giant trees, shady
paths, sparkling little lakes, lovely
vistas, birds and flowers.

An uncommonly
spacious and beautiful place to
build . . . and live.

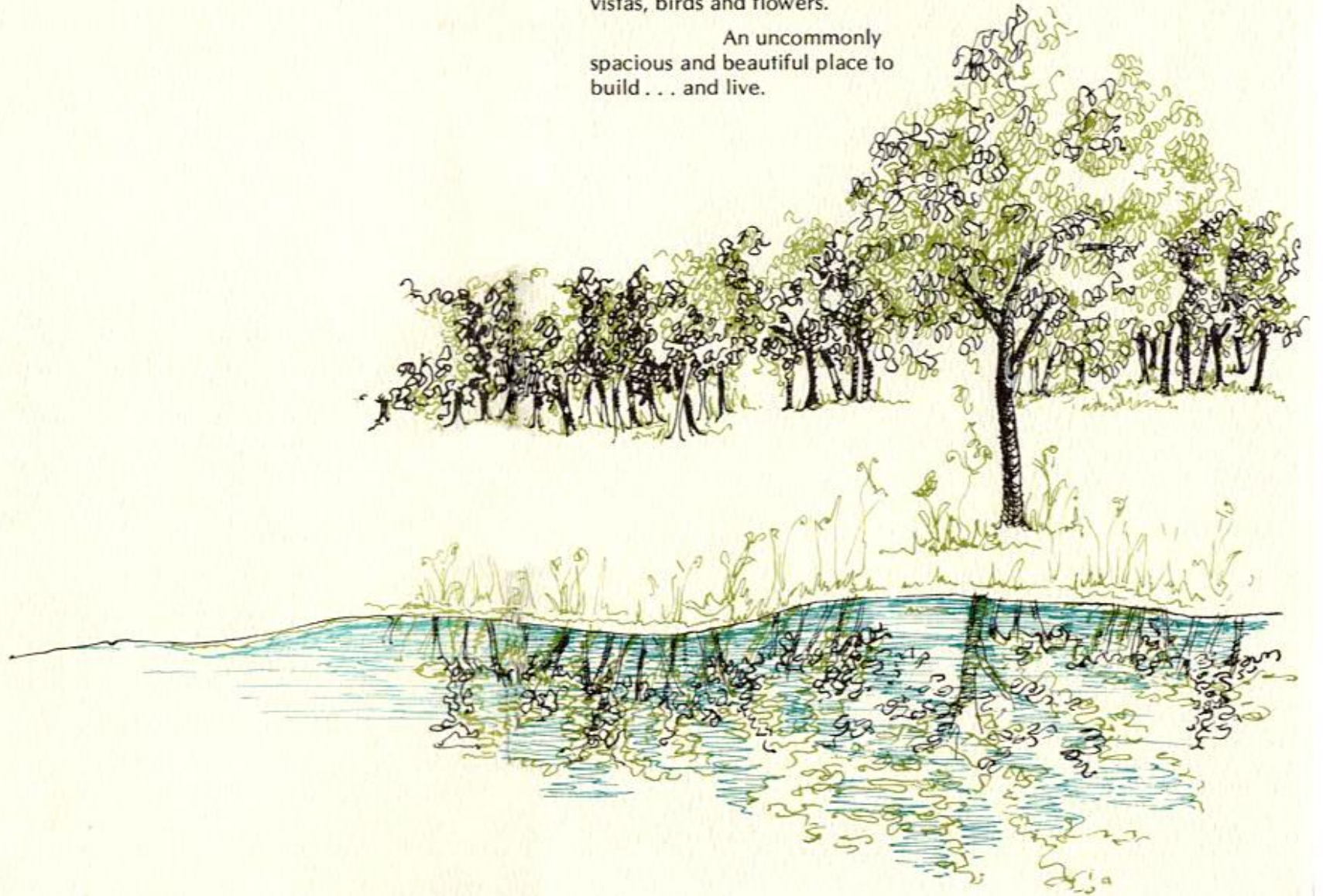

wind-n-wood

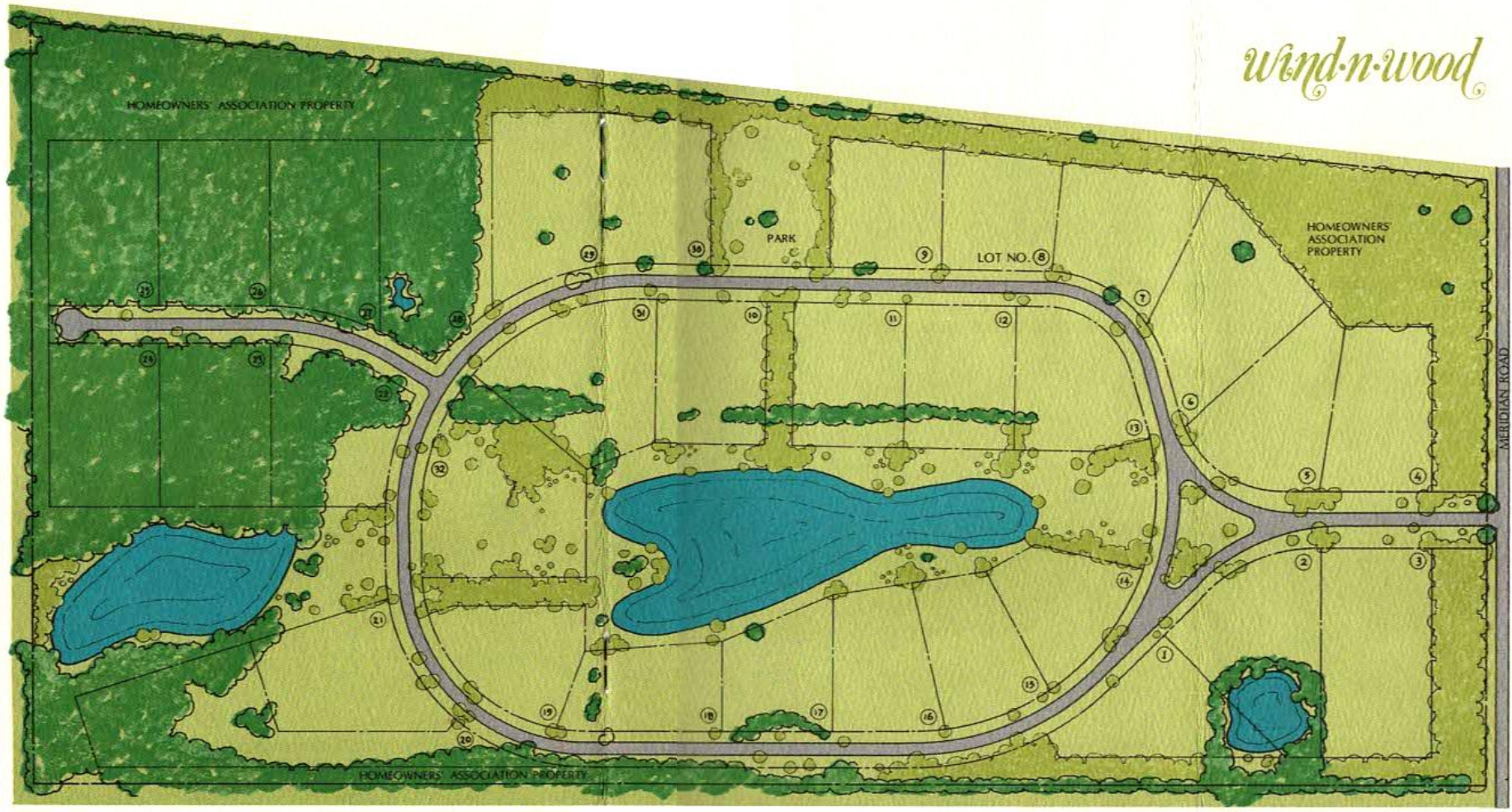

You are invited to come, explore, and fall in love with one of these spacious homesites, tucked into a wonderful parklike area with trees, foot paths, riding trails, birds, wild life, and picturesque little lakes—20 acres of common grounds including a wide green belt with Austrian pine plantings.

You become a member of the Wind-n-Wood Association when you contract for your site and you and your neighbors control these common grounds.

The services of a landscape architect preserve and add to the natural beauty.

Property restrictions protect your investment and your view.

Underground utilities; natural water from community wells.

Excellent Williamston schools with bus service.

A prestigious Okemos address.

Peace and beauty without measure.

And all this, just minutes from Meridian Mall's fine shops, MSU's cultural advantages and the historic state capitol.

The road home is
a peaceful lane among beautiful
trees, along a placid lake . . .

Wind-n-Wood.

Prestigious home-
sites in a planned community . . .

Come and see.

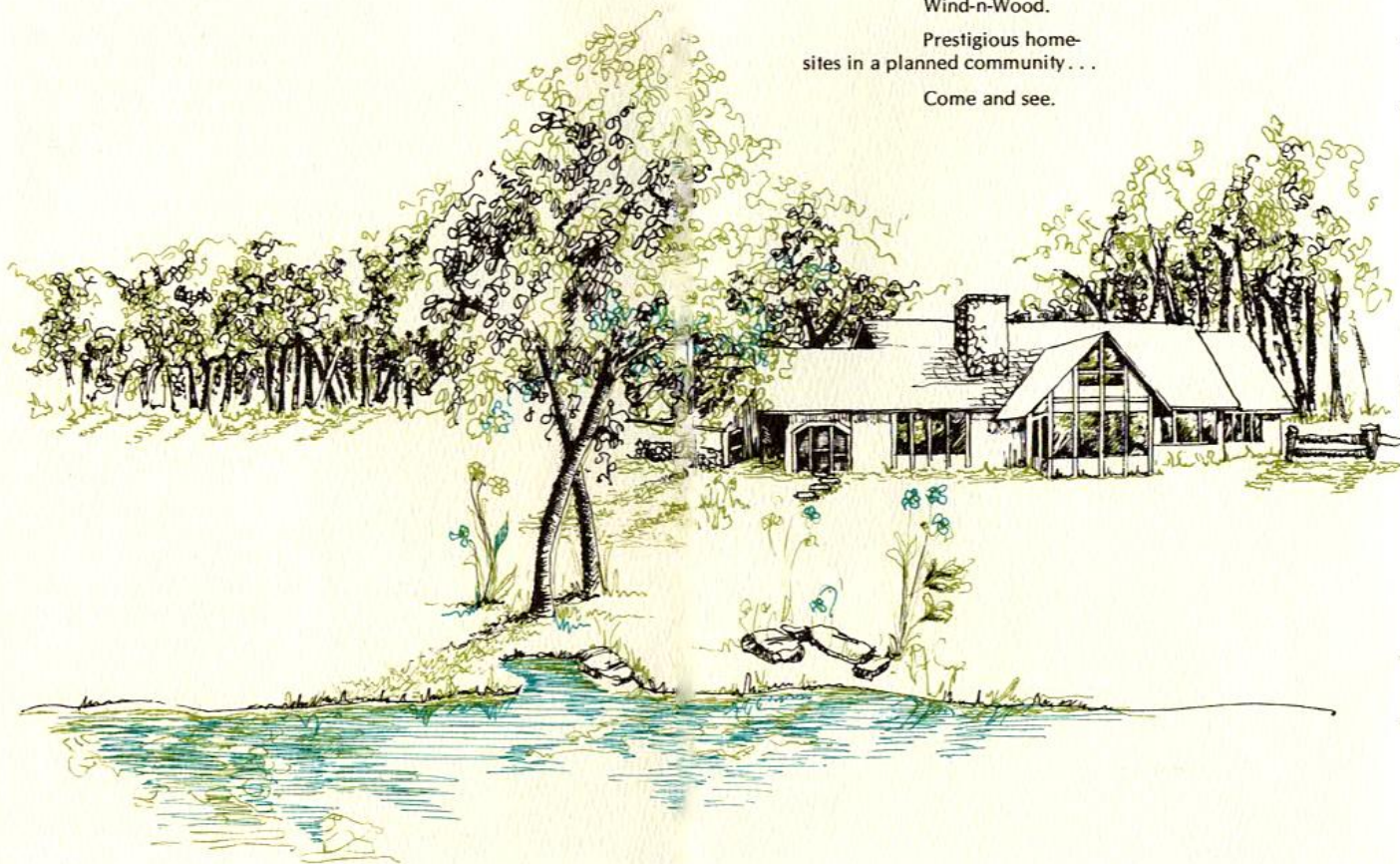

Wind-n-Wood offers uncommonly
spacious, beautiful and prestigious
homesites.

It also offers uncommon services
to its members.

Professional counsel in:

Selecting the homesite most
suited to the home you have
planned,

Designing a home most suited to
the site you choose,

Arranging your chosen site for
greatest comfort, beauty and
convenience,

Recommending a builder most
able to construct the home you
have in mind.

For those who must be, or choose
to be, relieved of day-to-day
monitoring of construction, there
is a Site-to-Finish option whereby
the developers of Wind-n-Wood
assume responsibility for efficient,
economical, and expeditious
construction—for seeing to it that
you get your money's worth and
the home you want, when you
want it.

Drive out Sunday to Wind-n-
Wood, (off Meridian between
Grand River and Jolly Road).

For information, call Wind-n-
Wood, 349-1326 [REDACTED]

Cole + Helen Brembeck